

LEZYNE 500XL LIGHT WITH G LINE BRACKET

IMPORTANT INFORMATION

- DO NOT LOOK DIRECTLY INTO LIGHT BEAM or shine into eyes of another.
- Lezyne LED Lights have a water resistance rating of IPX7 under IEC standard 60529. Submerging the device is not recommended. If moisture does enter the casing, air out until completely dry.
- It is vital that you follow the correct fitting procedure and tighten all fixings correctly
- Before using the bike, make sure the light is firmly secured to the bracket and functions properly
- DO NOT ATTEMPT TO REMOVE ELECTRONICS. Doing so will void warranty.
- Lezyne USA Inc or Brompton Bycycle Ltd. does not accept any liability for injuries or other damages resulting from the use of this product in any circumstances.
- If you are unsure of the correct fitting process, please consult your Brompton dealer or Brompton Technical Support support@brompton.co.uk

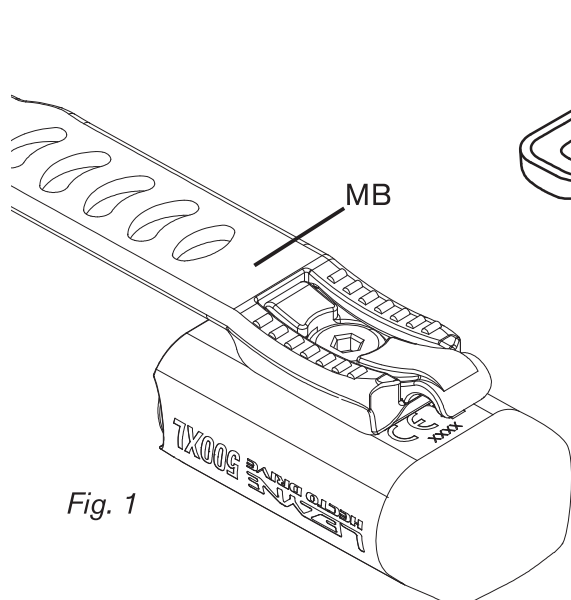

Fig. 1

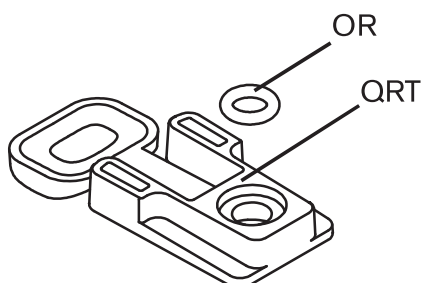

Fig. 2

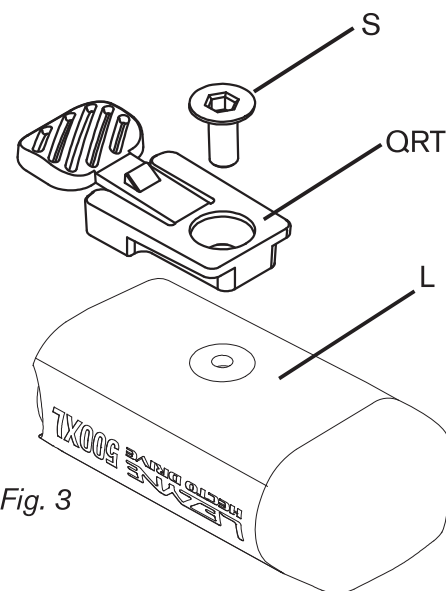

Fig. 3

Fitting The QR Tab

Remove the mounting band MB from the light by removing the screw. (fig. 1)

Fit the O-ring OR to the QR tab QRT. (fig. 2)

Fit the QRT to the light as shown. (fig. 3)

Fitting The Light Bracket To The Fork

Remove the pedal holder PH and bolt B by unscrewing the PH by using a 4mm hex key.

Fit the washer W to the bolt B, then the light bracket to the front fork as shown (fig. 4).

Tight to 9Nm.

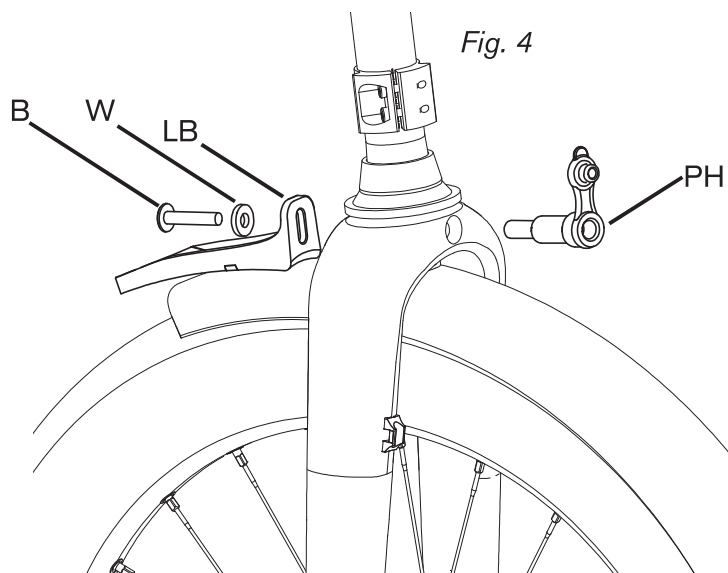

Fig. 4

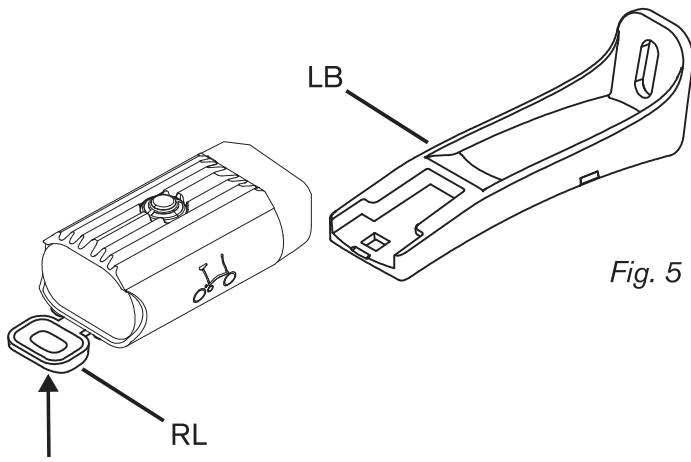

Fig. 5

Attaching The Light Bracket To The Bracket

To attach the light, align the it to the bracket and push till you hear a click. Pull to insure the light is attached.

To remove, push the release lever RL upwards while pulling the light away from the light bracket LB (fig. 5).

OPERATION

1. On/Off: hold button two (2) sec.
2. Mode cycle: click button

MODE MEMORY: The light remains in the output setting it is switched OFF in.

THERMAL PROTECTION: If the operating temperature of the light is too high, the light auto-matically lowers the lumen output

RUN TIMES AND MODES

	BLASTE	NDUROE	CONOMY	FEMTO	FLASH 1F	LASH 2	DAY FLASH	PULSE
	500 LUMENS	200 LUMENS	100 LUMENS	15 LUMENS	50 LUMENS	50 LUMENS	500 LUMENS	50 LUMENS
	1:00 h : min	2:00 h : min	4:00 h : min	20:00 h : min	13:30 h : min	13:30 h : min	5:45 h : min	15:00 h : min

BATTERY INDICATOR

100%



Illuminates green

50%



Illuminates yellow
or red/green

10%



Illuminates red

5%



Flashes red

CHARGING

Before using your Lezyne LED Light for the first time, fully charge battery.

To charge your light:

1. Switch light OFF
2. Remove USB protective cover
3. Insert USB plug into powered USB port
4. Once charging, button will flash green

If button does not flash when plugged in, selected USB port may not be powered—try another USB port.

Light will be charged after 3–4 hours or when button is solid green.

5. Remove light from charger and reinstall USB protective cover, ensure USB protective cover is fully installed for water resistance

Charging

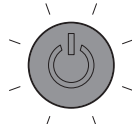

Flashes red

Fully Charged



Illuminates green

