

COLOUR TOUCH POINTS - A, C & P LINE

IMPORTANT INFORMATION

- Check to ensure that all listed parts are present
- If you are unsure of the correct fitting process, please consult your Brompton dealer or Brompton Technical Support support@brompton.co.uk

What's Included

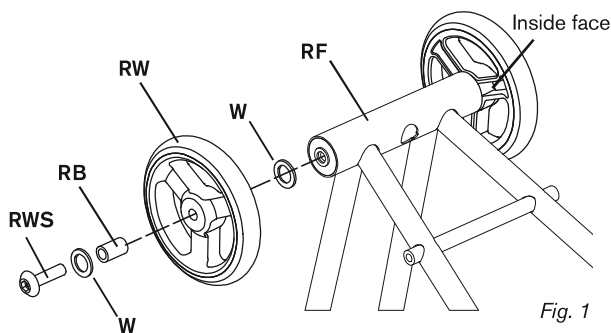
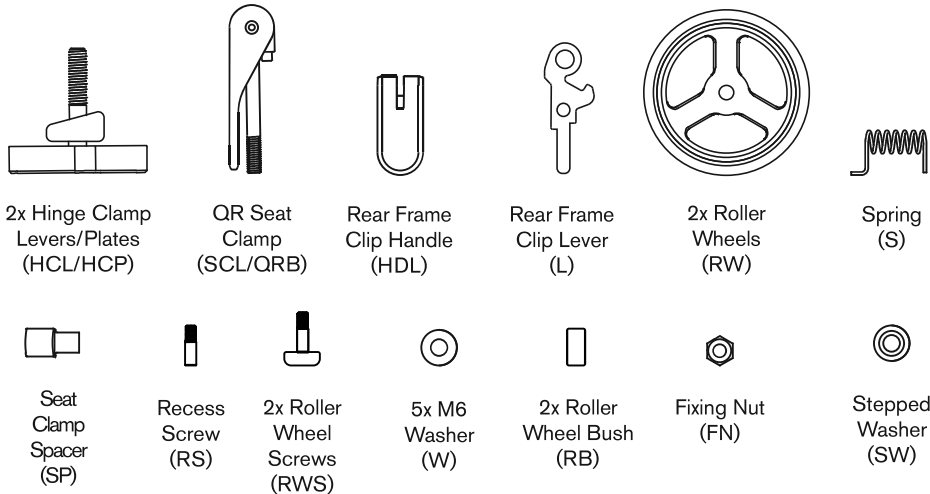

Roller Wheel

Fit the washer W and roller bush RB to the roller wheel screw RWS, then insert the roller wheel screw RWS into the roller wheel RW, followed by another washer W. Fit the RW with the inside face toward the rear frame RF as shown (fig. 1). Tighten to 4 Nm.

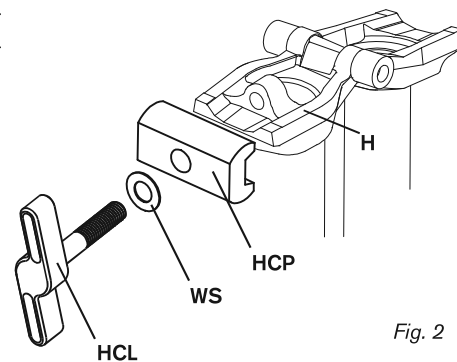

Hinge Clamp Lever - A,C&P Line

Unscrew the old lever to remove. Fit the new hinge clamp lever HCL and hinge clamp plate HCP by screwing it into the hinge H (fig. 2).

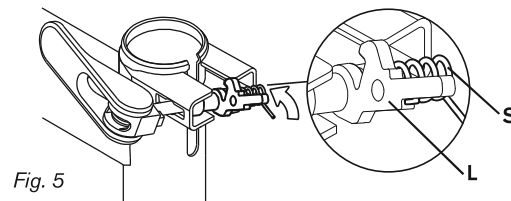
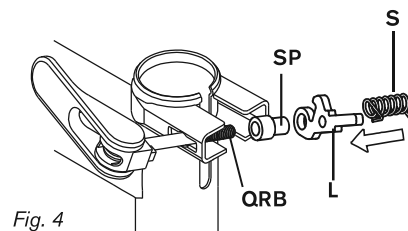
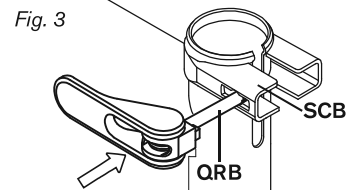

Quick Release & Rear Frame Clip

Feed the 6mm quick release bolt QRB through the slotted hole in the seat clamp band SCB as shown (fig. 3).

Load the frame clip components; spacer SP, lever L and spring S onto the quick release bolt QRB in the orientation shown (fig. 4). It is important that the bent end of the spring is resting flush at the bottom of the lever L as shown in the close-up (fig. 5) And the straight end of the spring S is resting against the seatclamp band SCB (fig. 5).

When the parts are loaded onto the bolt, feed the end of the bolt through the round hole in the other side of the seat clamp band SCB (fig. 6).

Fit the M6 washer WS followed by the fixing nut FN and tighten with a 10mm spanner (fig. 7). On some older models the usual 6mm hole on the other side of the seat clamp band SCB will be 8mm, in which case

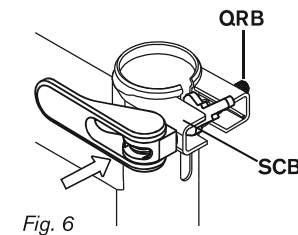

Push the lever L down towards the seat tube ST, (**Do not let go until the recess screw RS is fitted, as the handle can flick off forcefully**) continue to hold in position, then fit the handle HDL onto lever L. The handle HDL should be oriented with the logo facing upwards. (fig. 8).

While still holding the lever L and handle HDL in place, fit the recess screw RS and tighten to 2Nm (fig. 8). This screw should now hold the assembly together.

Check that the lever L moves and returns freely on the quick release bolt by operating the lever a few times.

Check that the lever L moves and returns freely on the quick release bolt by operating the lever a few times.

The quick release clamp should be adjusted so that the seat clamp lever SCL closes firmly when doing the quick release clamp up; if the clamp movement is slack, with little resistance, the seat post will not be properly secured. Test this by twisting the seat left and right ensuring that everything is firmly held in place. As a guide, with the seat clamp lever SCL closed (i.e. done up), the adjuster nut should be tightened to 6Nm. If the seatpost is slipping, tighten by 45 degrees. If the issue persist, contact a brompton dealer or brompton technical support.

